

Project by



:: RERA NO ::

PR/GJ/SURAT/SURAT CITY/SUDA/RAA06991/140520

Corporate Office

Raghuvir House, Nariman Shopping,  
City Light, Surat.  
Cell : 9638629131 / 7777953814  
www.raghuvirdevelopers.com

Follow us on

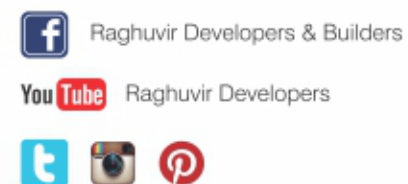

Download Now  

Site Address :

**RAGHUVIR SPECTRUM**  
B/H. Agrawal School,  
Near Second VIP Road, Vesu, Surat.



*Dream homes to match your  
Lifestyle and Attitude*

# WELCOME A CHANGE IN THE SURAT SKYLINE... EXCLUSIVE GREEN LIVING

Raghuvir Developers & Builders offers a charming blend of "Elite Living" with the best of contemporary amenities that ensures a warm and luxurious lifestyle in the finest address. The unique combination of vibrant surroundings, quality construction...



SILVER ELISUIM YOU  
HAVE BEEN WAITING FOR...





## YOU DREAM, WE VISUALIZE

Your home should give you a feeling of space. The doors and windows should create a path for the wind to travel and for the sun and moon to light up your home. The walls and security measures should give you a feeling of safety and comfort, Your home should be in harmony with the elements. When you know that you are living in a home that gives you all this, Like the one you have at Raghuvir Spectrum.



# A-B-E-F TOWER [3 BHK]

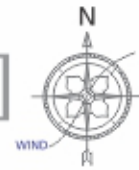

# C-D TOWER [3 BHK]



# G TOWER [4 BHK]

# FLOOR PLAN



SPECTRUM's blessed habitat and  
serene setting ,  
complete many lives holistically!!!

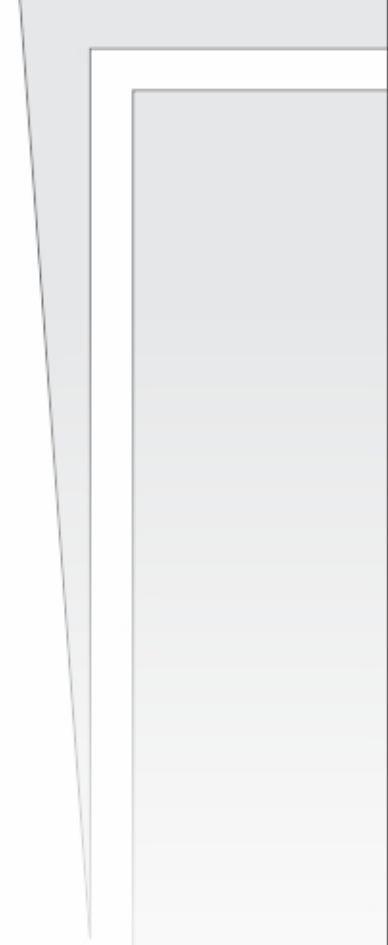



Listen to the chirping of birds.  
Expect greenery in every shade.



Senses with  
fantabulous fun



## BECAUSE KIDS LOVE TO PLAY

While as adults we all socialize, so do our kids, Spectrum has wonderfully equipped and fun play areas for your kids, so they can enjoy with people their own age.



## LUXURIOUS AMENITIES

### LUSH GREEN LANDSCAPE GARDEN

Landscape has party lawn for enjoying various celebrations, which includes :-

- Gazebo
- Glorious fountains
- Walk way in landscape
- Floral area in garden
- Amphitheatre
- Woman sitting
- Beautiful children play area
- Senior citizen sitting
- Deck sitting

### CLUB HOUSE

Which includes :-

- Provision for unisex gymnasium
- Changing room
- Steam
- Jacuzzi

### WELCOMING AREA

- Decent interior reception
- Guest waiting lounge with sofa and attachery
- Decent name plate of flat holders
- C.C.T.V. camera with 24 hours recording system for residents safety

### ALLOTTED PARKING

- Assured one car parking for each flat [ on ground or in basement ]



## UNIT SPECIFICATION

### FLOORING

- Italian type tile flooring in living, dining & kitchen
- Tile flooring in all other rooms

### KITCHEN

- "L" shaped stone platform with S.S. sink
- Tiles up to lintel level
- Wash basin in common area with tiles over dado

### REFLECTIVE GLASS

- Prerequisite of reflective glass in windows for protection from heat

### BATHROOM

- Bath fittings with single lever diverter by standard brand
- Tiles up to lintel level over dado & floor
- Wall hung water closet with seat cover
- Wall hung wash basin

### WINDOWS

- Anodized / power coated aluminium section with reflective glass for heat protection
- Polished granite sills
- Full height window in hall

### DOOR

- Pinewood main door frame
- Main door with laminate along with handle and safety lock
- Water resistant flush doors with stone frame and hardware fittings in all other doors

### ENAMEL

- Finished putty on internal walls of a flat
- Texture on external walls [ As per elevation requirement ] of the building with acrylic water based paint

### ELECTRIFICATION

- Modular switches
- Concealed wiring
- M.C.B. in individual flat for safety
- Two way light [1] & fan [1] points in living room and all other rooms
- 5/15 ampere electric points for electronic gadgets
- Electric points for A.C. in all bedrooms
- Electric point for T.V. in hall

### PLUMBING

- I.S.I. brand CPVC & UPVC plumbing & drainage piping
- Provision of central plumbing system for serving hot water [ flat wise ]

## CAMPUS FEATURES

### ENTRANCE GATE

- Elegant entrance gate on  $\cong$  60 feet wide T.P. road
- Security cabin
- Well designed project name plate

### LIFT

- Two automatic elevators of either Kone / Trio or equivalent
- Intercom in lift cabin
- Lift with M.S. / S.S. cabin

### ROAD

- Well finished paver block / R.C.C. road

### GENERATOR FACILITY

- Branded generator with 6 normal points in each flat & in common area for lift, water pumps, common passages & parking lights

## COMPOUND WALL

- Compound wall around the campus with provision of light points

## WATER TANK

- Underground & overhead water tank in each building

## WATER RECHARGE

- Percolating bore-well for rain water harvesting

## SAFE HOMES

### TITLE

- Loanable clear title
- Registered sale deed for individual members
- Building use certificate [BUC]
- Airport N.O.C.
- Lift licence
- Fire N.O.C.

## STRUCTURAL DESIGN

- Considering last earth quake

## FIRE SAFETY

- Fire safety provision as per N.O.C.

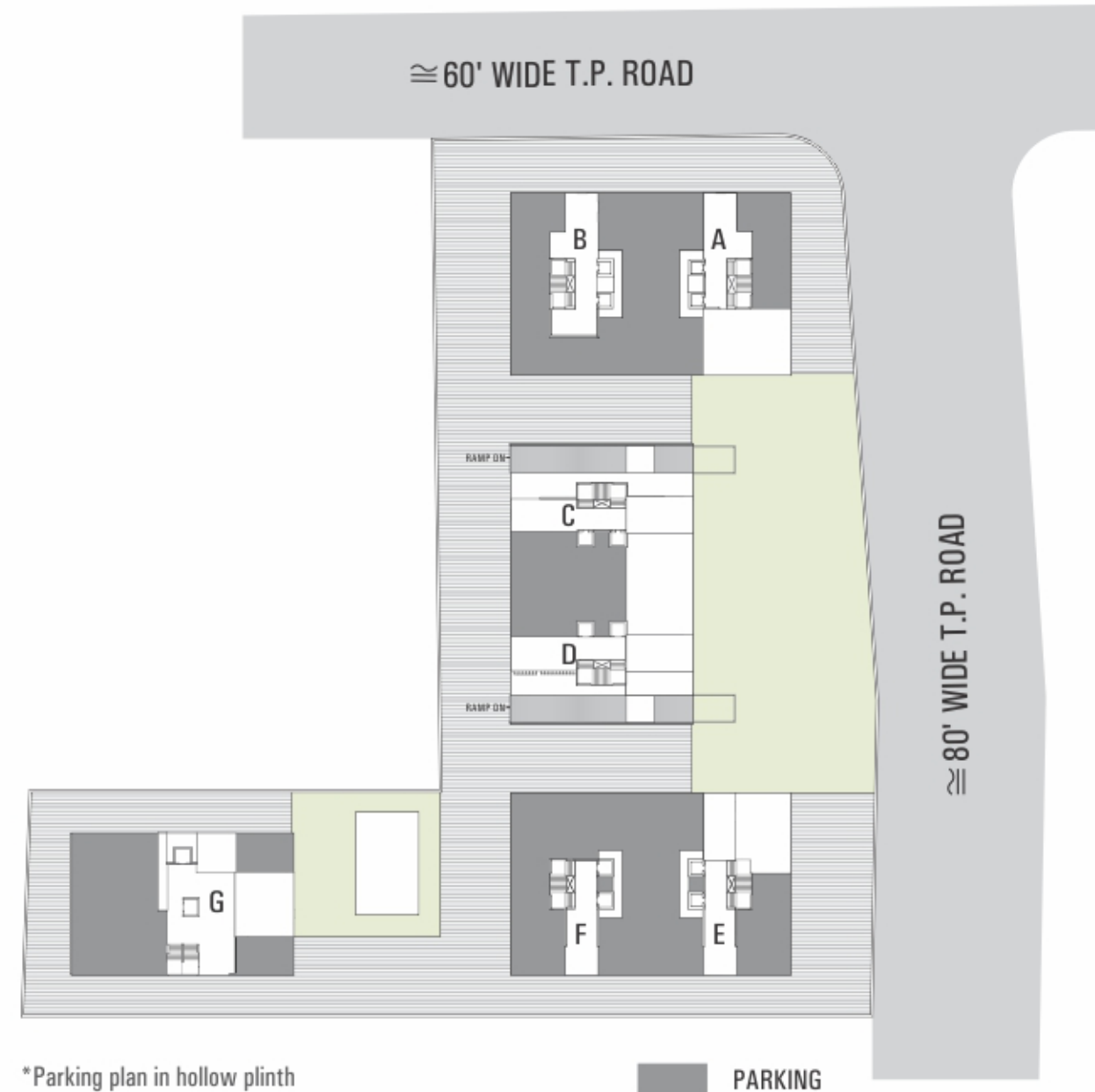

IGBC Green Homes  
Registered Project  
IGBCGH180264

Structural Design

KEYSTONE

Vikas Patel  
M.E. (Structure)



## Additional Value Added Amenities

01. RECEPTION & WAITING LOUNGE
02. AEROBIC
03. DISCO THEQUE
04. KIDS ZONE
05. BOARD GAME
06. MUSIC LIBRARY
07. LIBRARY
08. CONFERENCE ROOM
09. GYM
10. LADIES SPA
11. GENTS SPA
12. LOCKER
13. STEAM BATH
14. CHANGE ROOM
15. TOILET

**Note:-** All amenities shown here in, are not part of standard specification of this project but it shall be provided by Raghuvir Developers & Builders on free of cost basis for further value addition to the project. These amenities may get changed or cancelled only if more than 70% member of the society demand such changes (If possible). In case of cancellation of said value added amenities, Raghuvir Developers & Builders is not bounded to pay any type of compensation as it is being provided free of cost.





AEROBICS ROOM



GYM



BANQUET HALL



CONFERENCE HALL



JACUZZI



ADDITIONAL VALUE ADDED AMENITIES

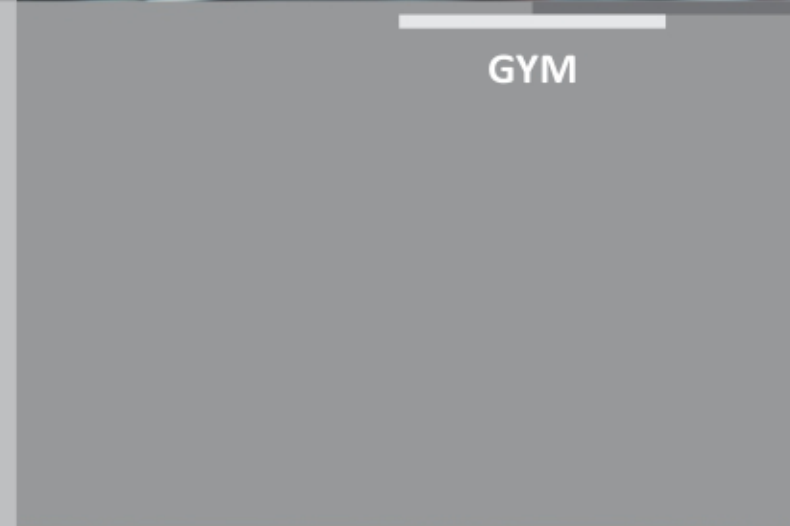

KIDS ZONE



ADDITIONAL VALUE ADDED AMENITIES



DISCO THEQUE



STEAM



Images shown here are meant for presentation purpose only.

Images shown here are meant for presentation purpose only.



MUSIC LIBRARY



LIBRARY

INDOOR GAME



Images shown here are meant for presentation purpose only.

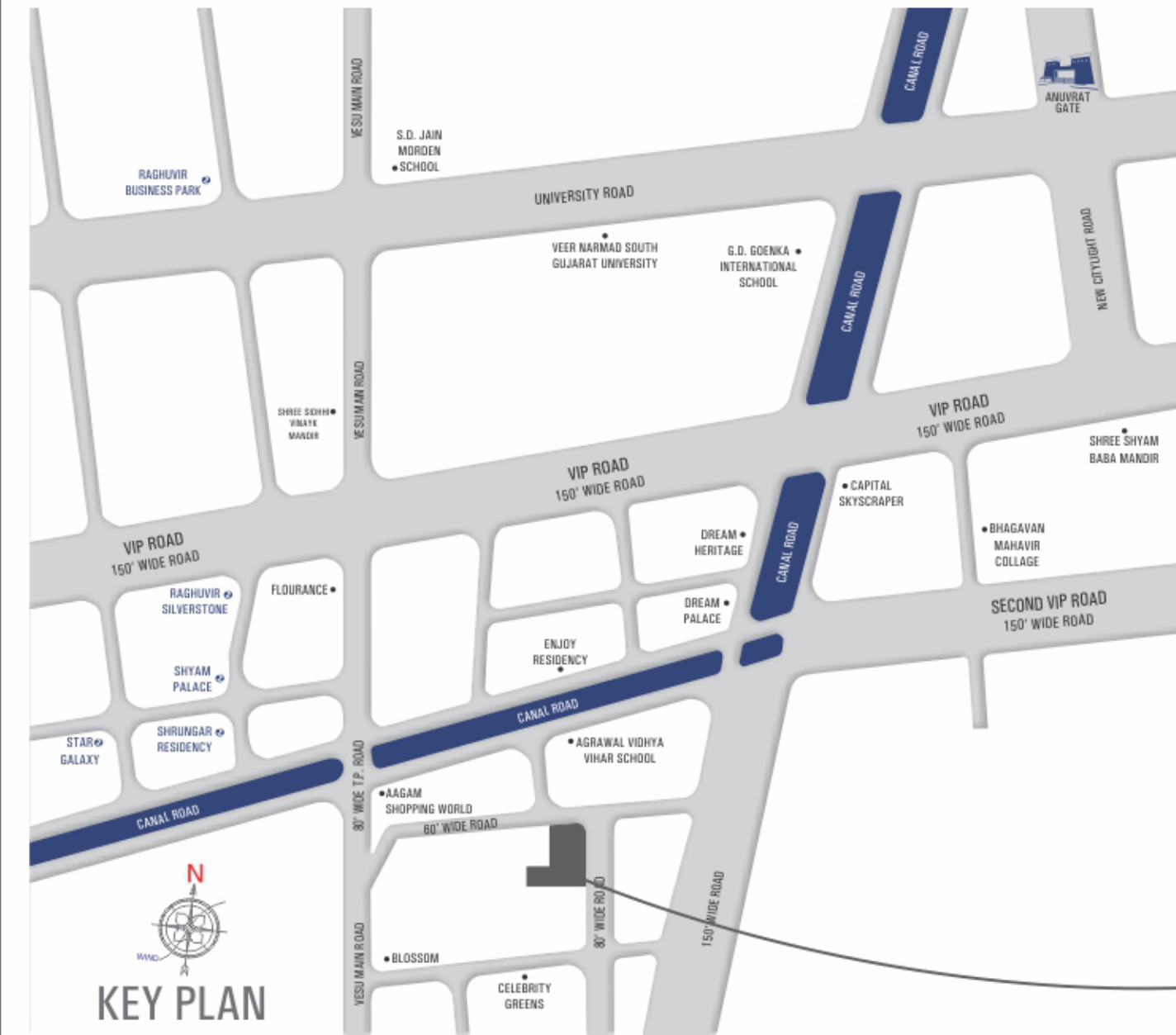

**Disclaimer:**

- Any amendments in rules & regulations by any authorities will be bound to all members. - All expenses of legal documents like Stamp duty, Registration fees, GST, Advocate fees, Incidental charges (drainage, water supply, IC, etc.) and every other charges like Society maintenance, Safety grill, SMC taxes, Gas connection, electrical connection charges (GEB charges, cabling, etc. including material & labours cost) are to be borne by members. - External & internal changes shall not be allowed. - Before possession, execution of sale deed is compulsory. - Members are bound to pay instalments regularly & irregularity in payment may cause cancellation of booking. Developers reserves right of making any changes in the scheme & it shall be bound to all members. - This booklet is only for private circulation and for general information to all the members & shall not form a part of any agreement. It can be changed without prior notice. - There may be difference in previous and recent brochure in manner of matter and content part, in those cases, recent brochure should be considered. - The interior design/ furniture work/ lighting/ plantation/ architectural presentation etc. shown in the brochure is just for the purpose of presentation/explanation to the members. It is not the part of the standard specification of the project, as unit is sold without furnitures.